

ORDINANCE NO. 82- 1112

BE IT ORDAINED BY THE TOWN COUNCIL OF THE TOWN OF BROOKWOOD, ALABAMA,
AS FOLLOWS:

The Corporate limits of the Town of Brookwood, Alabama are extended
to contain all of that property located in the West One-Half (1/2)
of the Southwest Quarter (1/4) of Section 36, Township 20 South,
Range 8 West, Tuscaloosa County, Alabama.

Attested by:

TOWN OF BROOKWOOD

Clara Pierce
Clerk, Town of Brookwood

Alton C. Ryche
ALTON C. RYCHE, Mayor

32: ARCA TO BE ANNEXED

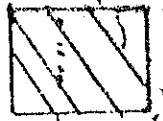

Section 36
Township 20 South
Range 10 West

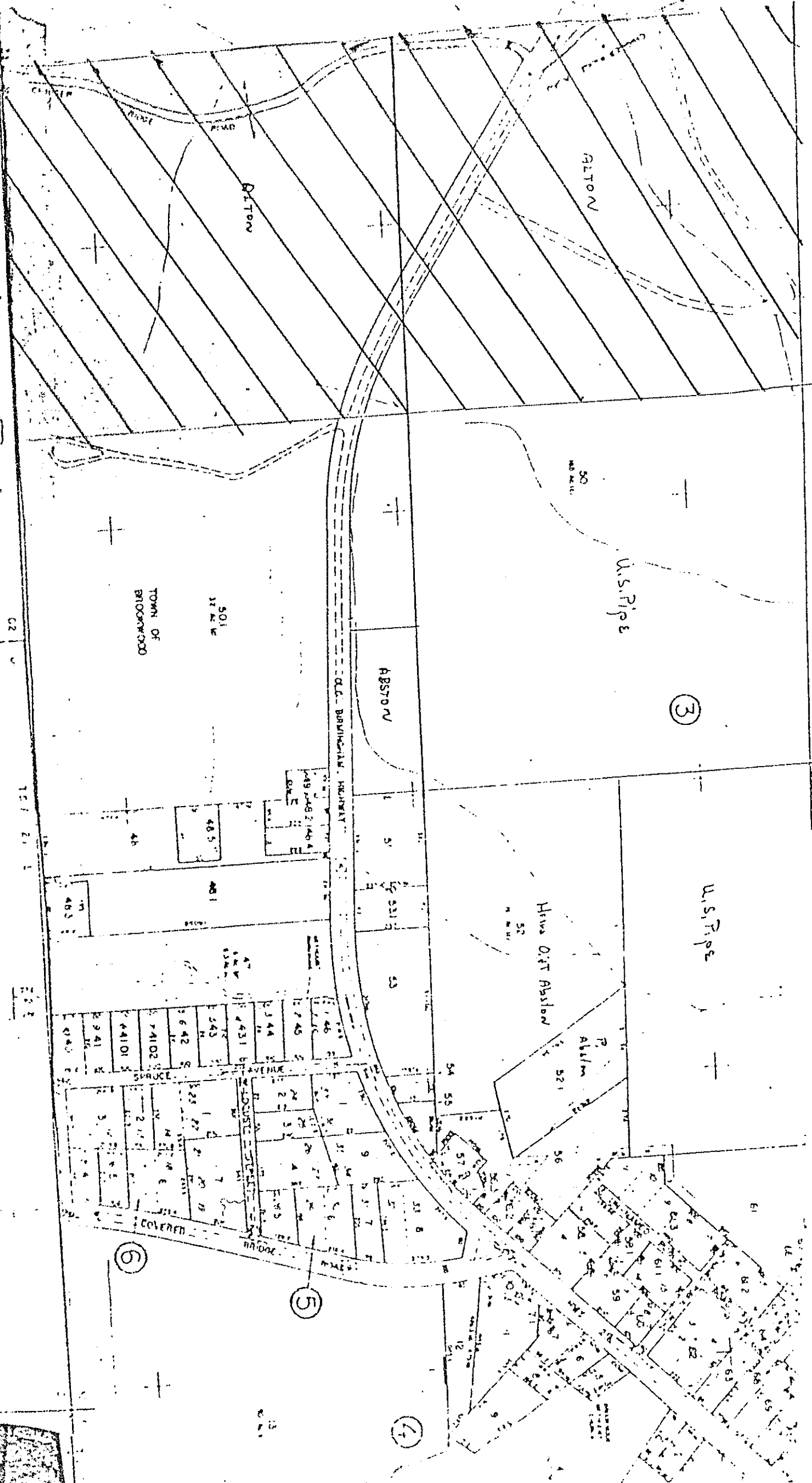

(3)

(6)

(5)

(4)